



**CITY OF HEATH, TEXAS
NOTICE OF PUBLIC HEARING BEFORE THE
CITY COUNCIL**

Notice is hereby given that the City Council of the City of Heath, Texas will hold a public hearing at a meeting that begins at 6:30 p.m. on Tuesday, August 13, 2018, at Heath City Hall, 200 Laurence Dr., Heath, Texas.

At such time and place, the City Council will conduct a public hearing and consider approval of a Resolution authorizing a Variance to Section 157.02 (C), "Fences," of the City of Heath Code of Ordinances, which requires fences in the front, side or rear yards abutting a street to have a maximum height of four (4) feet. The applicant is requesting to construct a five (5) foot high wrought iron type fence in the exterior side yard fronting Covenant Court. The subject property is zoned Planned Development District for Single-Family uses. **(Case No: FV-2019-02)**

<u>PROPERTY DESCRIPTION:</u>	Lot 16 of Block A, Providence Addition, City of Heath, Rockwall County, Texas. The subject property is addressed as 835 Providence Way. (Rockwall County CAD Map ID # 93910)
-------------------------------------	---

Information regarding the request may be downloaded from the Public Notices tab at www.heathtx.com . Interested citizens are invited to attend the public hearing and participate in the same.

Optional: The following may be filled out and returned to Heath City Hall before the hearing date.

Check one: **I am in favor of the request.** **I am opposed to the request.**

Reasons: (attach a separate sheet as needed)

Signature: _____
Name (printed): _____
Address: _____
Phone/Email Address (optional): _____

Please return this form to:

City of Heath
200 Laurence Drive
Heath, Texas 75032
(972-961-3066; fax 972-961-4935; email klasher@heathtx.com)

Thank you,
City of Heath, Texas

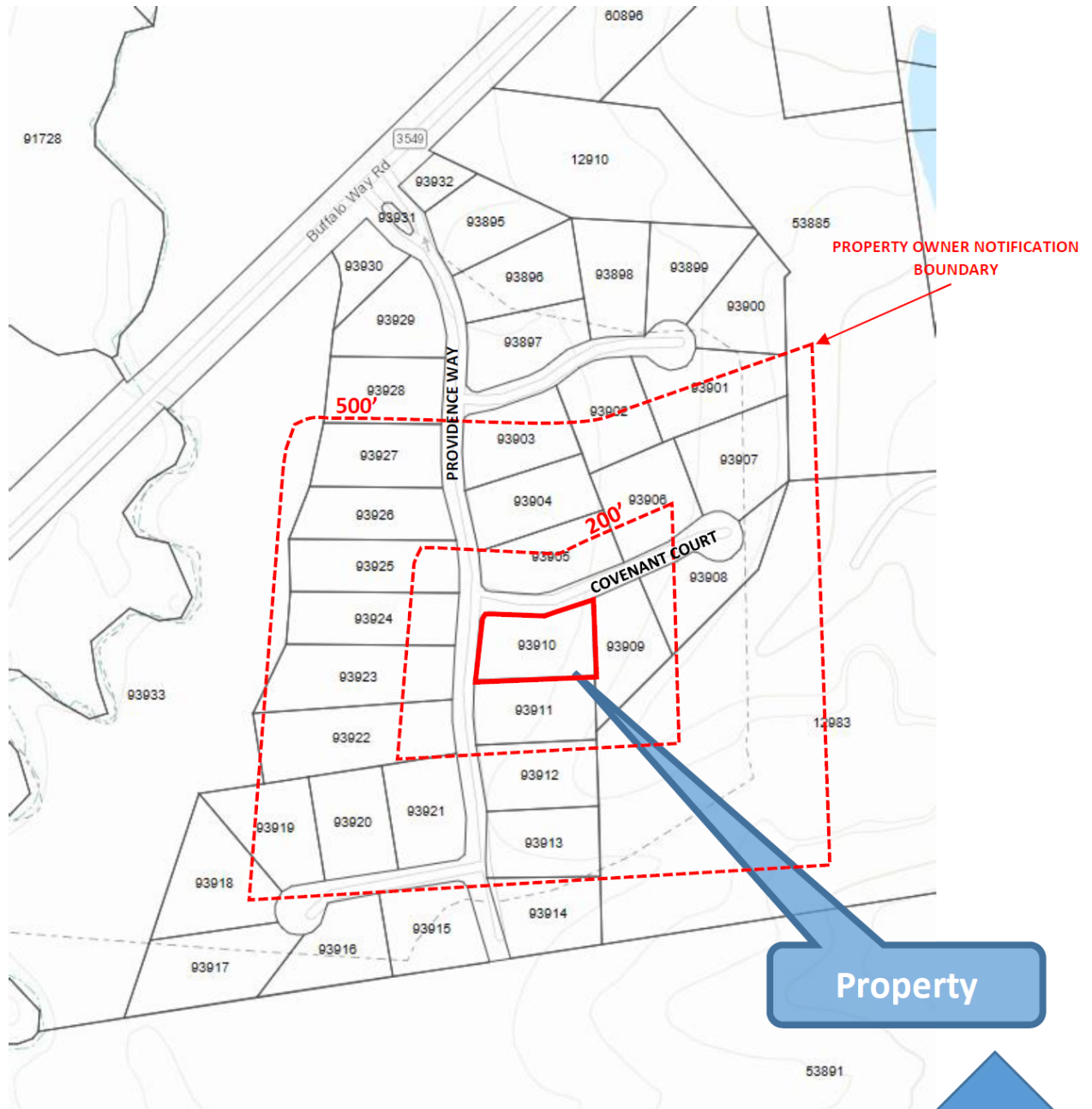

Vicinity Map
(Not to scale)

Case No. FV-2019-02:

Conduct a Public Hearing and consider approval of a Resolution Authorizing a Variance to Section 157.02 (C), "Fences," of the City of Heath Code of Ordinances, which requires fences in the front, side or rear yards abutting a street to have a maximum height of four (4) feet. The applicant is requesting to construct a five (5) foot high wrought iron type fence in the exterior side yard fronting Covenant Court, being Lot 16 of Block A, Providence Addition, City of Heath, Rockwall County, Texas. The subject property is addressed as 835 Providence Way and is zoned Planned Development District for Single-Family uses. **(Rockwall County CAD Map ID # 93910)**

